

APPROVED

REVISIONS				
ZONE	REV.	DESCRIPTION	DATE	APPROVED

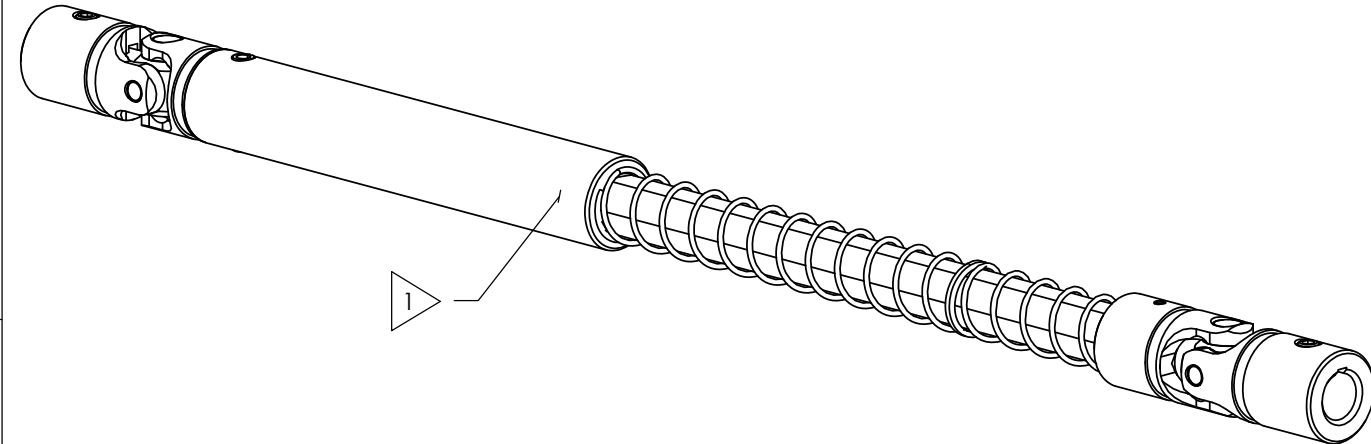

SCALE 1 : 1

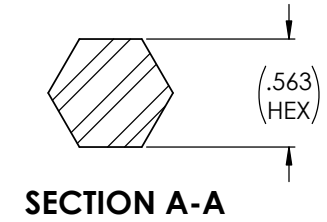

**FOR
REFERENCE
ONLY**

SOCKET SET SCREW, 1/4-20 x 3/16", CUP POINT, ALLOY STEEL 2X

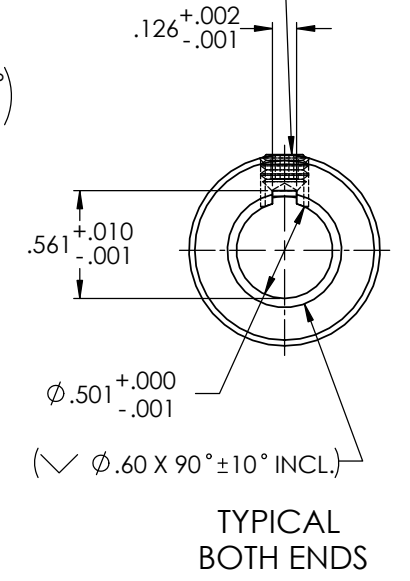
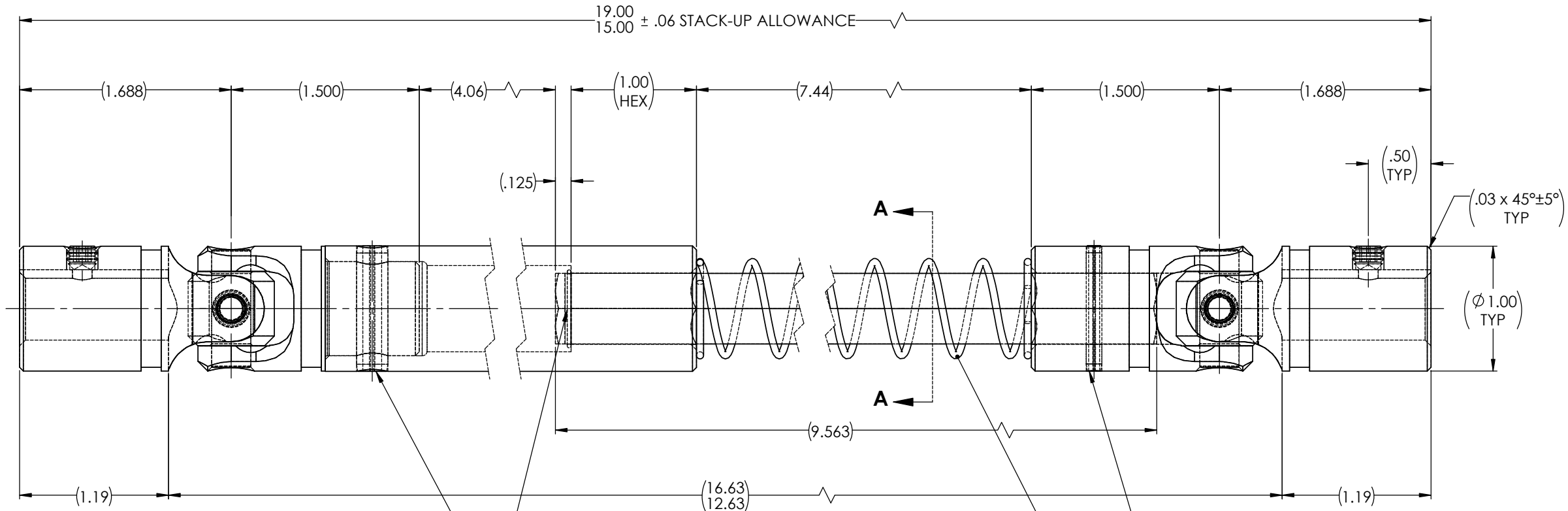

SPRING PIN, 1/4" x 1", SLOTTED, CARBON STEEL
DRILL Ø .250-.256" THRU @ ASSEMBLY

RETAINING RING

2X COMPRESSION SPRING
RATE = 3.07 Lbs/In
FORCE @ OPEN LGTH= 3.3 Lbf
FORCE @ CLOSED LGTH= 15.5 Lbf

SPRING PIN, 1/8" x 1", SLOTTED, CARBON STEEL
DRILL Ø .125-.129" THRU @ ASSEMBLY

TYPICAL
BOTH ENDS

NOTE(s), UNLESS OTHERWISE SPECIFIED.

1 MARK ASSEMBLY w/ "BELDEN" LOGO, PART NUMBER, REVISION LEVEL, DATE OF MANUFACTURE (MO/YR) & BELDEN JOB No.

(2) LUBRICATE UNIVERSAL JOINTS & HEX SHAFT w/ LUBRIPLATE # 1200-2, NLGI GRADE 2, AW/EP, LITHIUM GREASE.

DO NOT SCALE DRAWING

UNLESS OTHERWISE SPECIFIED CHAMFER ALL HOLES BREAK ALL SHARP CORNERS DE-BURR ALL FEATURES	STANDARD TOLERANCES, UNLESS OTHERWISE SPECIFIED DIMENSIONS ARE IN INCHES (mm)	MATERIAL: ALLOY STEEL	INITIALS	DATE	Belden Universal www.beldenuniversal.com	
			DRAWN	JP		17 JAN 23
TURNED SURFACES: 63/	ANGULAR MACHINED: ±1.0°	HEAT TREAT: SEE DETAIL DRAWINGS	CHECKED	RNK	05/25/2023	
MILLED SURFACES: 125/	FRACTIONAL: ±.015"		ENG APPR.	RNK	08/31/2023	ASSEMBLY, DRIVE SHAFT
	TWO PLACE DECIMAL: ±.010"		MFG APPR.			
	THREE PLACE DECIMAL: ±.005"		QUALITY			
	FOUR PLACE DECIMAL: ±.0005"	FINISH/COATING: NONE	COMMENTS:		SIZE DWG. NO. B TUJ-HD1000x500K-L	
	CONCENTRICITY: .0025" T.I.R.				SCALE: 2:1 WEIGHT (Lbs): 2.365 SHEET 1 OF 2	
PROPRIETARY AND CONFIDENTIAL THE INFORMATION CONTAINED IN THIS DRAWING IS THE SOLE PROPERTY OF BELDEN UNIVERSAL. ANY REPRODUCTION IN PART OR AS A WHOLE WITHOUT THE WRITTEN PERMISSION OF BELDEN UNIVERSAL IS PROHIBITED.	ALL HOLES TO BE LOCATED ON CENTERLINE (Q) WITHIN .005" T.I.R. INTERPRET GEOMETRIC TOLERANCES I.A.W. ASME Y14.5				REV	