

REVISIONS				
ZONE	REV.	DESCRIPTION	DATE	APPROVED

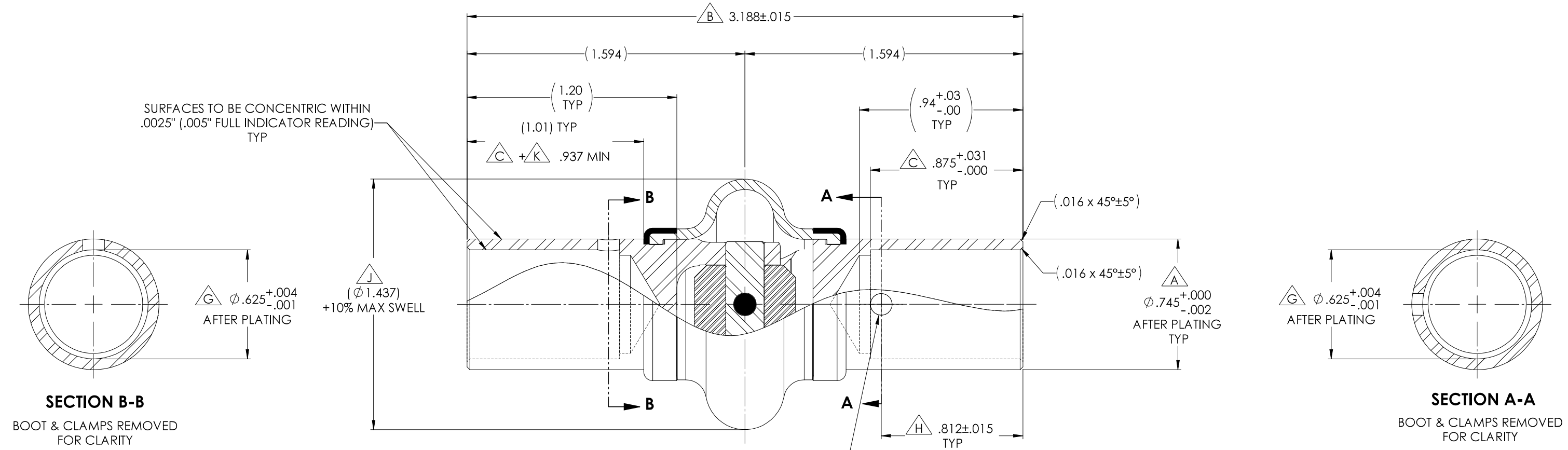

NOTE(s), UNLESS OTHERWISE SPECIFIED.

- (1) REF., FINISH ALL EXTERNAL STEEL COMPONENTS: CADMIUM PLATE I.A.W. SAE-AMS-QQ-P-416, TYPE II (YELLOW CHROMATE), CLASS 2.
- (2) IDENTIFICATION: ELECTRO-ETCH or LASER MARK ASSEMBLY w/ NAME, PART NUMBER, MANUFACTURER CAGE CODE, DATE OF MFR (MO/YR), & BELDEN JOB NUMBER APPROXIMATELY WHERE SHOWN.

BELDEN
MS20271B12
1R6X2 MO/YR
(JOB No.)

- (3) LUBRICATION: LUBRICANT TO CONSIST OF A UNIFORM MIXTURE OF GREASE CONFORMING TO MIL-PRF-32014 or MIL-PRF-81322 WITH A 6±1/2 % BY WEIGHT ADDITIVE MOLYBDENUM DISULFIDE. LUBRICANT CONFORMING TO SAE-AMS-M-7866.
- (4) CLOSURE (BOOT): MUST BE RESISTANT TO OZONE CRACKING AND BE ABLE TO RETAIN THE LUBRICANT AT ALL TEMPERATURES BETWEEN -67° F (-55° C) AND 160° F (71° C) DURING OPERATION.
- (5) ANGULARITY: MUST BE OPERABLE TO A MINIMUM ANGLE OF 30°.
- (6) TORSIONAL PLAY (BACKLASH): .41-.43° @ 3.9 TO 4.1 IN-LBS.
- (7) END PLAY: .0027" TOTAL WITH A 5 LB LOAD APPLIED IN BOTH DIRECTIONS WITHOUT LUBRICANT OR COVER.
- (8) SIDE PLAY: .0055" TOTAL WITH A 5 LB LOAD APPLIED IN BOTH DIRECTIONS WITHOUT LUBRICANT OR COVER.
- (9) ULTIMATE STATIC TORQUE: 1,900 IN-LBS ± 2%.
- (10) ULTIMATE TENSILE OR COMPRESSIVE STRENGTH: 2,000 LBS ± 2%.
- (11) DESIGNED I.A.W. MIL-DTL-6193, CLASS 2, TYPE B & MS20271.
- (12) FLAG NOTES A, B, C ... CORRESPOND TO DIMENSIONS AS LABELED ON SPECIFICATION MS20271.

**FOR
REFERENCE
ONLY**

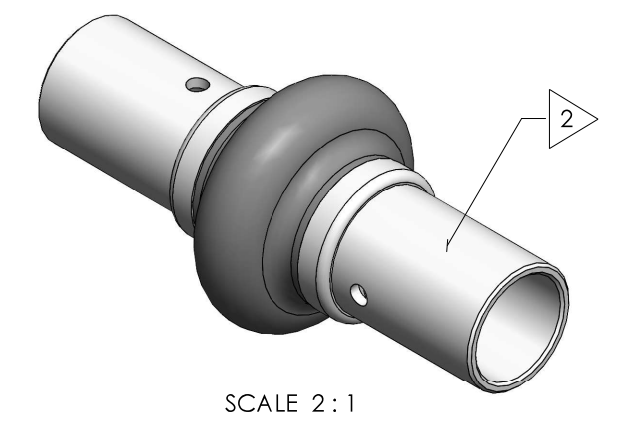

DO NOT SCALE DRAWING

UNLESS OTHERWISE SPECIFIED CHAMFER ALL HOLES BREAK ALL SHARP CORNERS DE-BURR ALL FEATURES	STANDARD TOLERANCES, UNLESS OTHERWISE SPECIFIED DIMENSIONS ARE IN INCHES (mm)	MATERIAL:	INITIALS	DATE	Belden Universal www.beldenuniversal.com
		ALLOY STEEL	RNK	07FEB96	
TURNED SURFACES: \checkmark_{63}	ANGULAR MACHINED: ±1.0° FRACTIONAL: ±.015" TWO PLACE DECIMAL: ±.010" THREE PLACE DECIMAL: ±.005" FOUR PLACE DECIMAL: ±.0005" CONCENTRICITY: .0025" T.I.R.	HEAT TREAT:	ENG APPR.	RNK	11NOV09
		SEE DETAIL DRAWINGS	MFG APPR.		
MILLED SURFACES: \checkmark_{125}	ALL HOLES TO BE LOCATED ON CENTERLINE (Q) WITHIN .005" T.I.R.	FINISH/COATING:	COMMENTS:		SIZE DWG. NO.
PROPRIETARY AND CONFIDENTIAL THE INFORMATION CONTAINED IN THIS DRAWING IS THE SOLE PROPERTY OF BELDEN UNIVERSAL. ANY REPRODUCTION IN PART OR AS A WHOLE WITHOUT THE WRITTEN PERMISSION OF BELDEN UNIVERSAL IS PROHIBITED.	INTERPRET GEOMETRIC TOLERANCES I.A.W. ASME Y14.5	CADMIUM PLATED			B MS20271B12
					SCALE: 3.5:1 WEIGHT (Lbs): 0.214 SHEET 1 OF 2