

APPROVED

| REVISIONS | | | | |
|-----------|------|-------------|------|----------|
| ZONE | REV. | DESCRIPTION | DATE | APPROVED |
| | | | | |

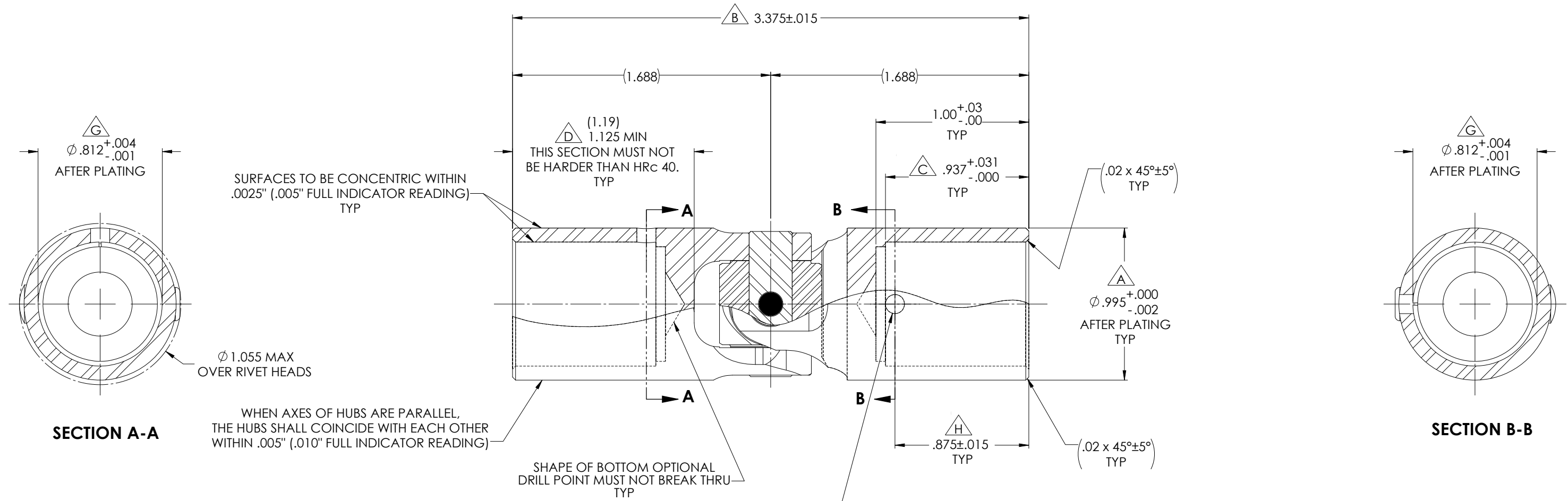

NOTES(s), UNLESS OTHERWISE SPECIFIED.

- (1) UNIVERSAL JOINT DESIGNED AND TESTED I.A.W. MIL-DTL-6193, CLASS 1 AND MS20270, TYPE B.
- (2) REFERENCE, FINISH: ALL EXTERNAL STEEL COMPONENTS, EXCEPT RIVET; CADMIUM PLATED I.A.W. SAE AMS-QQ-P-416, TYPE II (YELLOW CHROMATE), CLASS 2.
- 3 IDENTIFICATION: MARK (ELECTRO-ETCH or LASER MARK) ASSEMBLY w/ NAME, PART NUMBER, MANUFACTURER CAGE CODE, DATE OF MANUFACTURE (MO/YR), & BELDEN JOB No. I.A.W. MIL-STD-130 AS SHOWN.

BELDEN
MS20270B16
1R6X2 (MO/YR)
(JOB No.)

- (4) LUBRICATION: LUBRICATE WITH OIL CONFORMING TO MIL-PRF-7870.
- (5) ANGULARITY: MUST BE OPERABLE TO A MINIMUM ANGLE OF 30°.
- (6) MAXIMUM ALLOWABLE TORSIONAL PLAY (BACKLASH): 0.40° (± 2%) @ 8 IN-LBS (± 2%).
- (7) MAXIMUM ALLOWABLE END PLAY: .0035" TOTAL WITH A 5 LB LOAD APPLIED IN BOTH DIRECTIONS WITHOUT LUBRICANT.
- (8) MAXIMUM ALLOWABLE SIDE PLAY: .0080" TOTAL WITH A 5 LB LOAD APPLIED IN BOTH DIRECTIONS WITHOUT LUBRICANT.
- (9) REF., ULTIMATE (BREAKING) STATIC TORQUE: 2,500 (± 2%) IN-LBS.
- (10) REF., ULTIMATE TENSILE OR COMPRESSIVE STRENGTH: 600 LBS (± 2%).
- (11) REF., DYNAMIC TORQUE ENDURANCE TEST: 375 IN-LBS (± 2%) AT 120 RPM AND A 15° OPERATING ANGLE FOR 2 HRS.
- (12) FLAG NOTES **A**, **B**, **C** ... CORRESPOND TO DIMENSIONS AS LABELED ON SPECIFICATION MS20270.

Ø.125^{+0.004}/_{-.001} INSPECTION HOLE THRU ONE WALL ONLY.
CENTERLINE SHALL LIE IN A DIRECTION PARALLEL TO THE PIVOT CENTERLINE OF THE YOKE EAR HOLES WITHIN 1° TYP

**FOR
REFERENCE
ONLY**

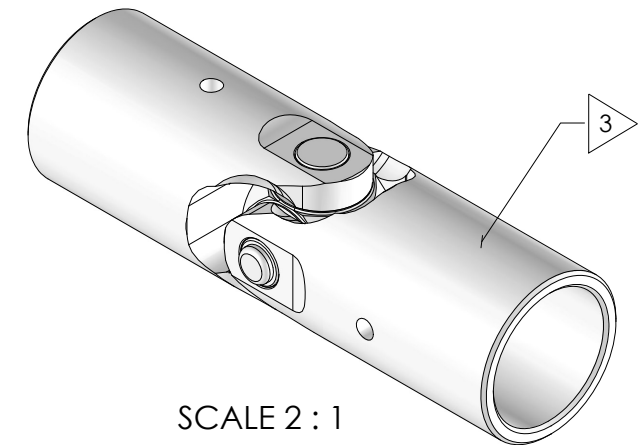

SCALE 2 : 1

DO NOT SCALE DRAWING

| | | | | | |
|---|---|---------------------|-----------|---------|---|
| UNLESS OTHERWISE SPECIFIED: CHAMFER ALL HOLES BREAK ALL SHARP CORNERS DE-BURR ALL FEATURES | STANDARD TOLERANCES, UNLESS OTHERWISE SPECIFIED DIMENSIONS ARE IN INCHES [mm] | MATERIAL: | INITIALS | DATE | Belden Universal www.beldenuniversal.com |
| | | ALLOY STEEL | RNK | 30JAN02 | |
| TURNED SURFACES: \checkmark_{63} | ANGULAR MACHINED: ±1.0° | HEAT TREAT: | ENG APPR. | RNK | 30JAN02 |
| MILLED SURFACES: \checkmark_{125} | FRACTIONAL: ±.015" | SEE DETAIL DRAWINGS | MFG APPR. | | |
| | TWO PLACE DECIMAL: ±.010" | | QUALITY | | |
| | THREE PLACE DECIMAL: ±.005" | | COMMENTS: | | |
| | FOUR PLACE DECIMAL: ±.0005" | FINISH/COATING: | | | |
| | CONCENTRICITY: .0025" T.I.R. | CADMIUM PLATED | | | |
| PROPRIETARY AND CONFIDENTIAL THE INFORMATION CONTAINED IN THIS DRAWING IS THE SOLE PROPERTY OF BELDEN UNIVERSAL. ANY REPRODUCTION IN PART OR AS A WHOLE WITHOUT THE WRITTEN PERMISSION OF BELDEN UNIVERSAL IS PROHIBITED. | ALL HOLES TO BE LOCATED ON CENTERLINE (Q) WITHIN .005" T.I.R. INTERPRET GEOMETRIC TOLERANCES I.A.W. ASME Y14.5 | | | | SIZE DWG. NO. B MS20270B16 |
| | | | | | SCALE: 3:1 WEIGHT (Lbs): 0.366 SHEET 1 OF 2 |